



Pam Arcade, Kottara Chowki  
Mangalore - 575 006. Ph : 0824 4268045  
E: agrajagroup2010@gmail.com  
[www.agrajabuilders.com](http://www.agrajabuilders.com)

ARCHITECTS  
**S.G. ASSOCIATES**  
Near Infosys, Kottara Chowki, Mangalore - 575 006  
Mob: +91 93432 92044

FOR BOOKINGS CONTACT  
**+91 9513 88 00 66**

RERA REGISTERED NUMBER  
PRM/KA/RERA/1257/334/PR/200103/003109



#### ONGOING PROJECTS



AGRAJA LEGEND  
NEERMARGA



AGRAJA ATHARVA  
Mulky

#### COMPLETED PROJECTS



AGRAJA BAPPANADU RESIDENCY  
Mulky



AGRAJA SAROVAR  
Mulky



AGRAJA GARDEN  
Surathkal



AGRAJA VIVANTA  
Mangalore



AGRAJA SHILAS  
Mangalore



AGRAJA AMBARI  
Mulki



AGRAJA SAMPADA  
Surathkal



INDULGE IN AN  
exuberant  
way of life

AGRAJA  
**isharada**  
SURATHKAL



INFINITELY  
incredible

The sideways of metropolis interests more than its central landscapes! They are vibrant and offer energetic lifestyles. It is always enthusing to be near the Sea but not very closer to it. The distant murmurs of Sea waves adds a sort of ingenuity to our psyche making it more energetic and deeply thrilled!

Suratkal with its fast developing industrial and educational infrastructure and its innate greenery too adds to a unique life style hitherto not offered in any other location! "Agraja Sharada" name symbolising pinnacle of virtue, greatness will be offering you with finer homes and lucrative business opportunities.

A total of 54 shops with ample space ambience well suited to the coastal environment and perfected with modern fixtures and accessories. Suratkal is away from 4 kms from Baikampady industrial area, New Mangalore port while it is situated in close congruity to NITK, Srinivas groups of institutions and reputed schools and institutions too! The place is surrounded by all the civic amenities, variety shopping including local merchandise shopping, health care and enthralling beaches at the vicinity!

Commercial ventures are part of the great scenario of modern day life with every shades of business and retail taking place in a small and big way ! Agraja Sharada will have 31 apartments (1/2/3 BHK) with unique spaces for establishing start-ups, opening branded retail shops or professional offices and so on! Business and ventures have their own way of shaping up and moving into big domain. The basement, G Floor and further 5 floors will be offering you with enough space to move on and enjoy your spaces and live up your dreams with ecstasy and empowerment.

AGRAJA  
इशारदा  
SURATHKAL





# SPECIFICATIONS

- ◆ R.C.C Foundation as per Structural Engineers Requirement.
- ◆ 8" thick External Wall used
- ◆ 4" thick Wall internal partition wall with bond lintal (solid block)
- ◆ 6" thick lintal with necessary steel (cut lintal)
- ◆ 20" wide cut 3" bearing to external wall
- ◆ RCC Slab 5" thick with necessary steel
- ◆ Steel consumption as per design (calculated steel by structural designers)

## KITCHEN AND WORK AREA

- ◆ Adequate electric power point provision for water purifiers
- ◆ Provision for exhaust fan
- ◆ Granite platform with stainless steel sink
- ◆ Plumbing and drainage connection with power point for washing machine
- ◆ Power Point for refrigerator and microwave oven

## DRAWING / DINING

- ◆ Vitrified tile flooring.
- ◆ Two - way electrical system with modular switches.
- ◆ TV points and telephone/cable TV connection.
- ◆ Wash basin Provision.

## BEDROOM

- ◆ Power supply for AC (for all bedrooms)
- ◆ Two way light control in all bedrooms
- ◆ Telephones, TV points and Cable TV Connection in all bedrooms.

## ELEVATORS

- ◆ S.S cabin with attractive roof lights
- ◆ Risk-free operation

## BALCONIES

- ◆ Separate Drain pipe to drain out the water
- ◆ Elegant balcony railing with safety measures
- ◆ Ceramic anti skid tiles
- ◆ Electrical points for pleasure usage (Water proof fittings)

## MATERIAL SPECIFICATION

### DOORS & WINDOWS

- ◆ Main Doors: Attractive Melamine
- ◆ Polished Decorative Main Entrance Doors.
- ◆ Inside Doors: Concrete Frames with Flush Door Shutters for Bed Rooms & RCC Frames with fibro Tech Shutters For Toilets.
- ◆ Modular Front Door Loc.
- ◆ Quality Aluminium Sliding Windows.

### PAINTING

- ◆ Door & Window Grills: Enamel Painting over Car Putty Finish.
- ◆ Wall: 2 Coat Acrylic Emulsions over Putty Finish & Primer Coat.

### ELECTRICAL

- ◆ High Quality Standard Cables (Finolex or RR).
- ◆ Modular Switch Boards & Switches.
- ◆ Premium Quality Electrical Wires

### PLUMBING

- ◆ Modular & Quality Tap & Fittings.
- ◆ Hind Ware or Parry Ware Commode & Wash Basin.
- ◆ C.P.V.C Concealed Pipes & Stainless Steel Sink with Mat Finish.







GROUND FLOOR PLAN



FIRST FLOOR PLAN

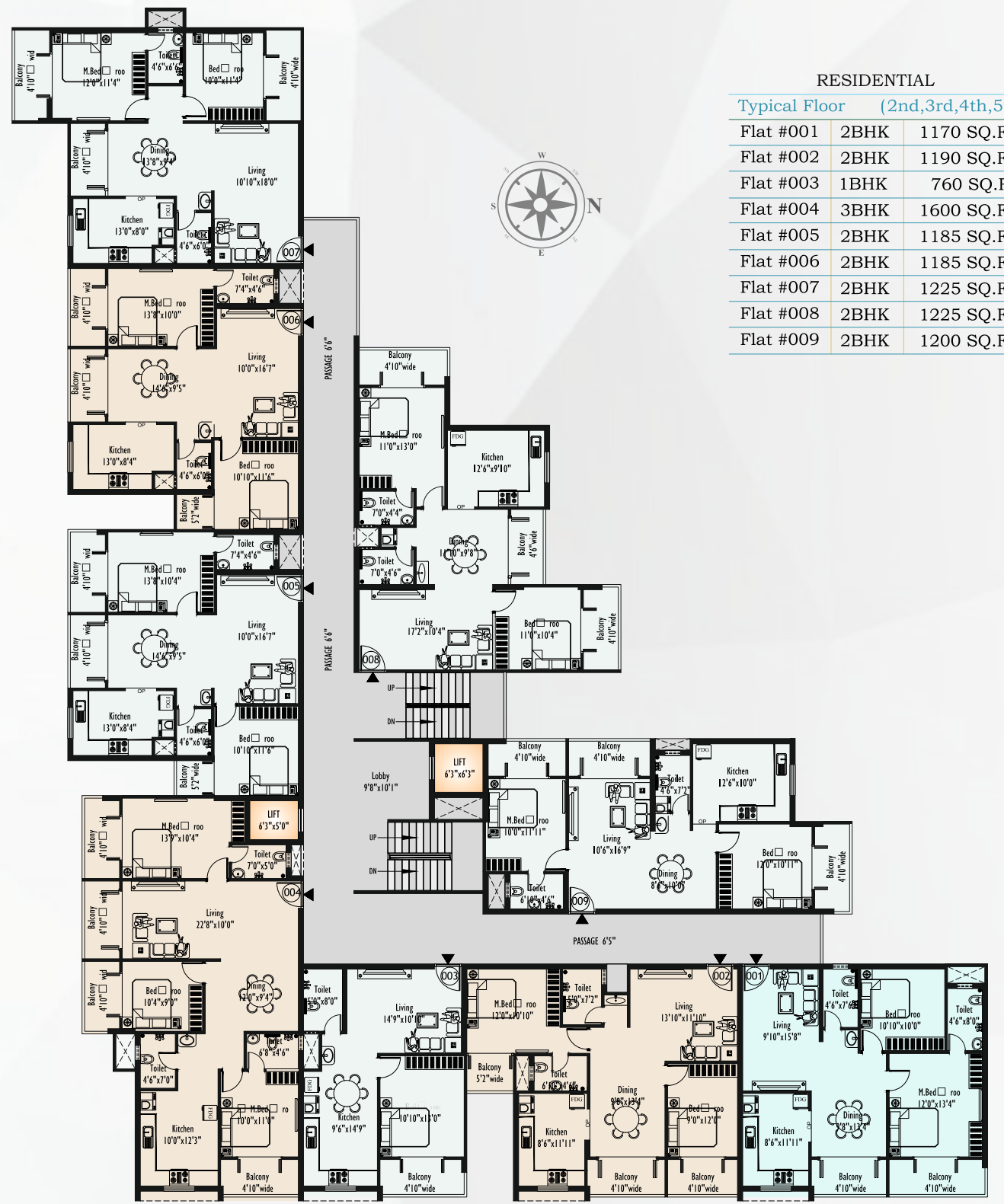

TYPICAL FLOOR PLAN (2nd 3rd,4th,5th)